

LANCEMORE

MANSION HOTEL

WERRIBEE PARK



MEETING AND
BANQUET ROOMS

MEETING & BANQUET ROOMS

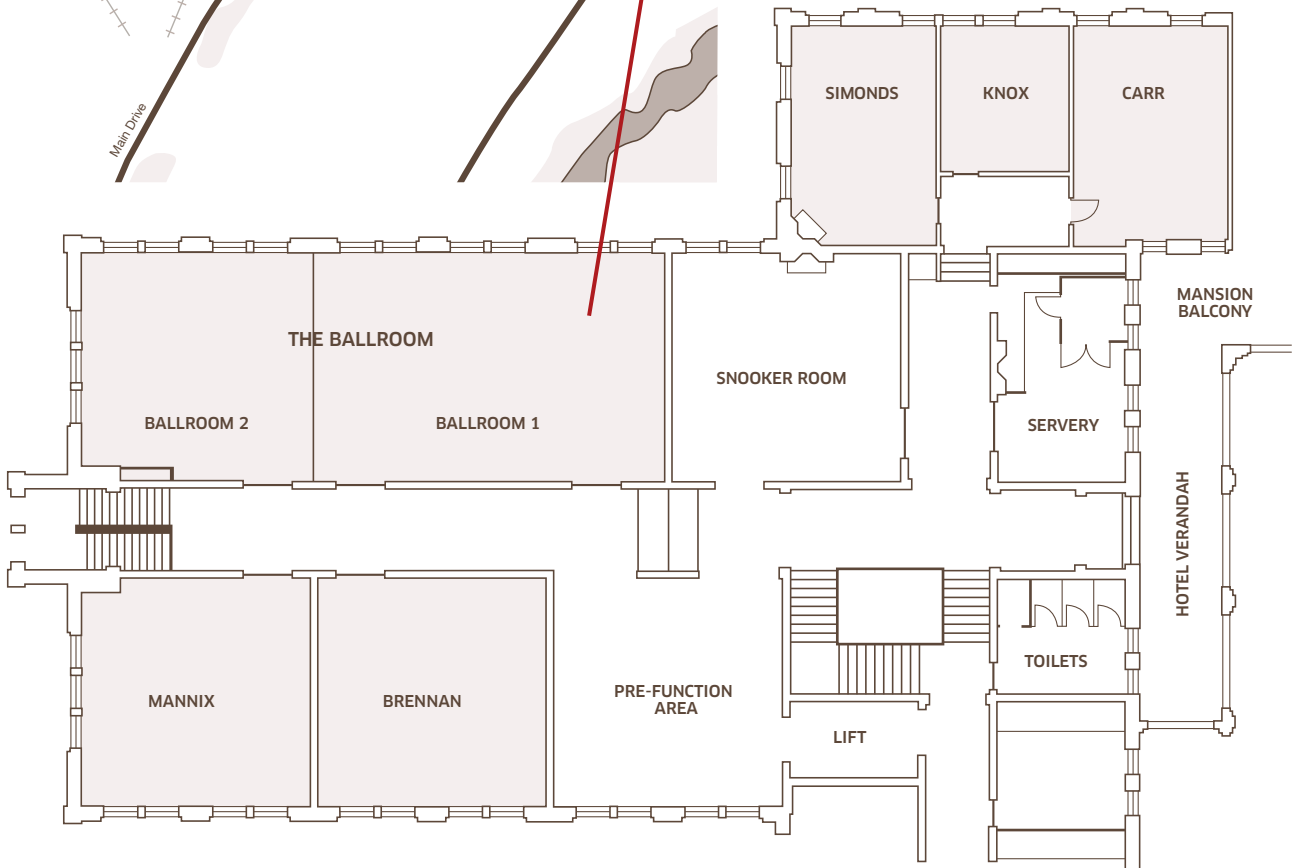
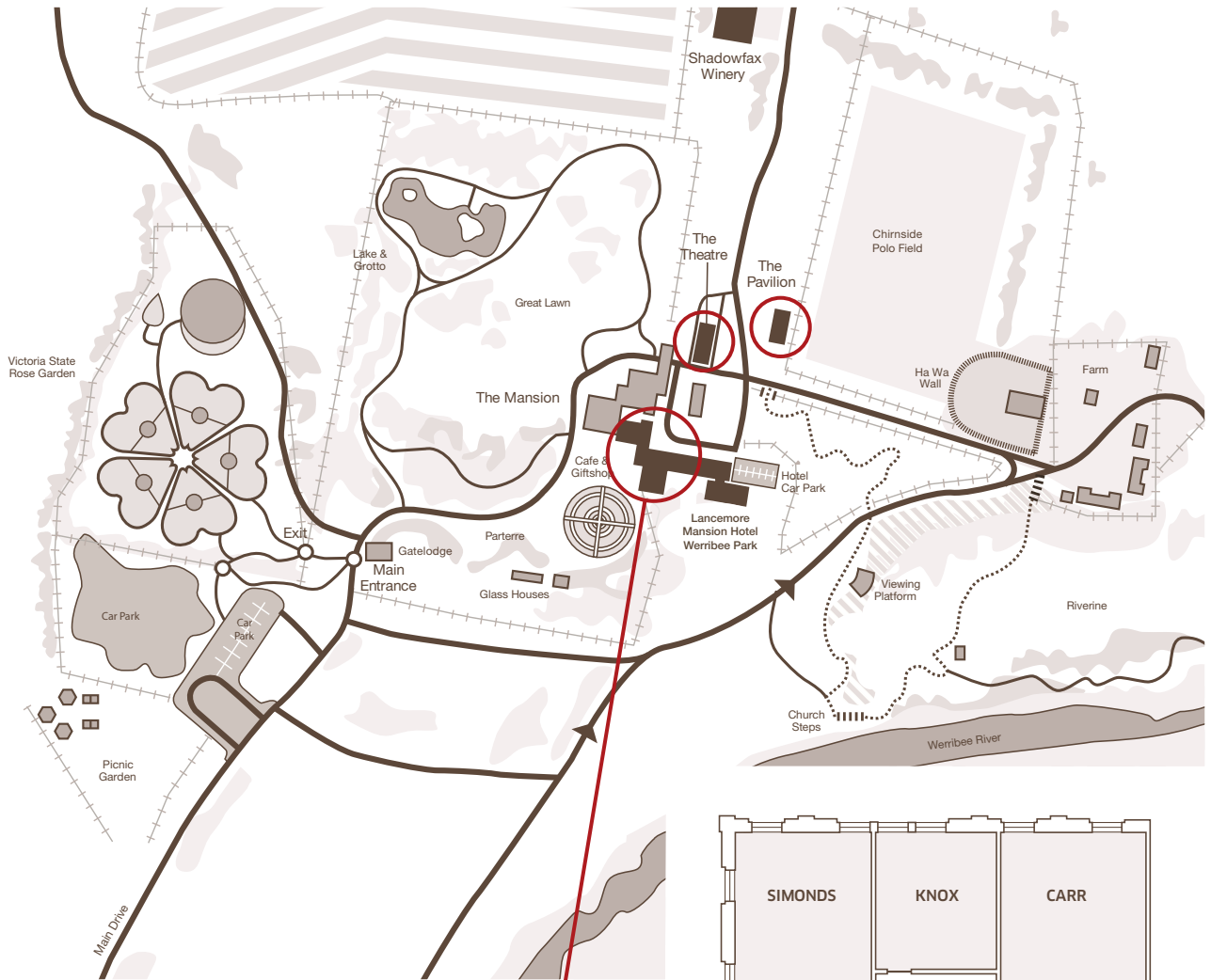

BOARDROOMS / MEETING ROOMS

One Executive Boardroom, one small boardroom, two larger meeting rooms and The Ballroom are located within the hotel and offer audio-visual facilities.

THE THEATRE

Beautifully refurbished, The Theatre provides seating for a maximum of 140 guests in banquet style. French doors open onto gardens.

THE PAVILION

A contemporary function room with an outside decking, overlooking the Chirnside Polo Field. The Pavilion provides seating for a maximum of 120 guests in banquet style.

AUDIO/VISUAL CAPABILITIES

Purpose-designed audio-visual capabilities through the hotels in-house provider, Audio-Visual Dynamics. Including standard, advanced, high speed internet access and cabled broadband/wireless access available in all conference rooms.

ROOM CAPACITIES

| | Area (sqm) | Height (m) | Theatre | Cabaret | Classroom | Cocktail | Banquet | U-shape | Boardroom |
|--------------|------------|------------|---------|---------|-----------|----------|---------|---------|-----------|
| Simonds | 35.3 | 3.9 | - | - | - | - | - | - | 12 |
| Knox | 20.2 | 3.9 | - | - | - | - | - | - | 8 |
| Carr | 35.3 | 3.9 | 24 | 16 | - | - | 20 | - | 14 |
| Ballroom | 146.2 | 4.4 | 100 | 80 | 80 | - | 100 | 45 | 44 |
| Ballroom One | 86.2 | 4.4 | 60 | 40 | 54 | - | 60 | 30 | 26 |
| Ballroom Two | 60.0 | 4.4 | 40 | 24 | 27 | - | 30 | 20 | 20 |
| Mannix | 56.7 | 4 | 40 | 24 | 27 | - | 40 | 20 | 20 |
| Brennan | 56.2 | 4 | 40 | 24 | 27 | - | 40 | 20 | 20 |
| The Theatre | 180.0 | 6.5 | 140 | 112 | 96 | - | 140 | 56 | 48 |
| The Pavilion | 167.4 | 4.2 | 40 | 40 | 45 | 120 | 120 | 30 | 30 |

SIMONDS, KNOX & CARR

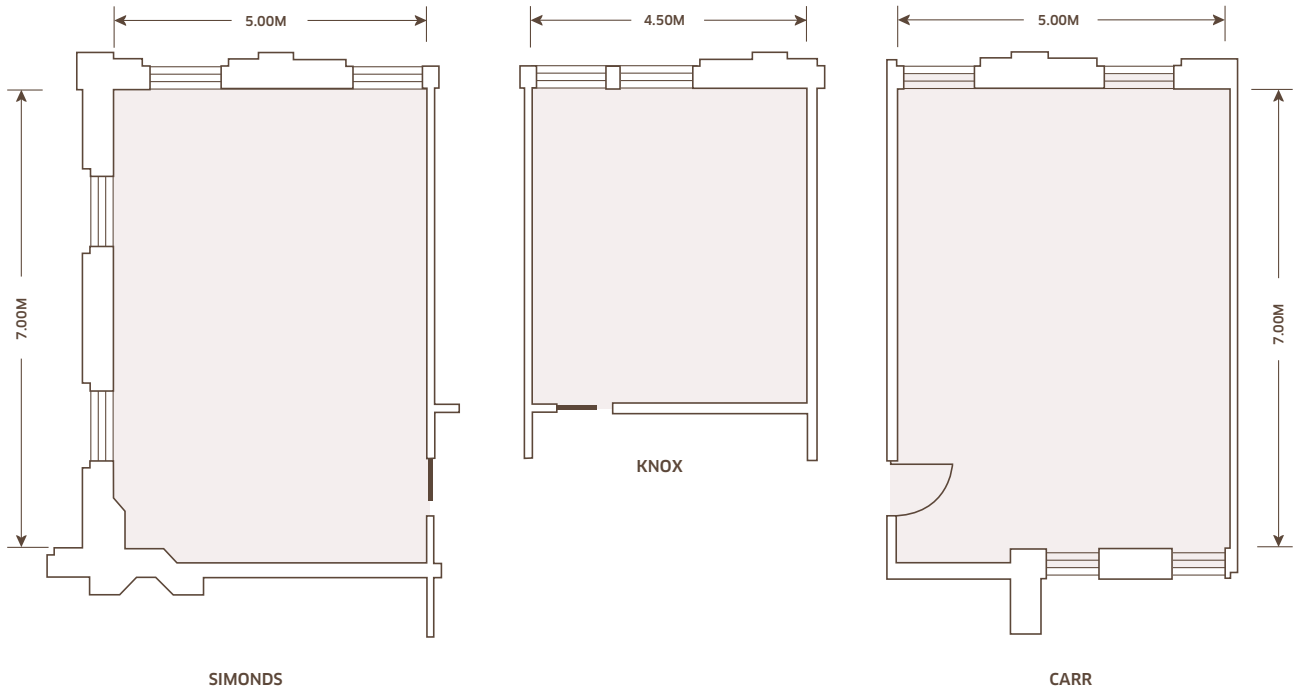

ROOM CAPACITIES

| | Area (sqm) | Height (m) | Theatre | Cabaret | Classroom | Cocktail | Banquet | U-shape | Boardroom |
|----------------|------------|------------|---------|---------|-----------|----------|---------|---------|-----------|
| Simonds | 35.3 | 3.9 | - | - | - | - | - | - | 12 |
| Knox | 20.2 | 3.9 | - | - | - | - | - | - | 8 |
| Carr | 35.3 | 3.9 | 24 | 16 | - | - | 20 | - | 14 |

THE BALLROOM

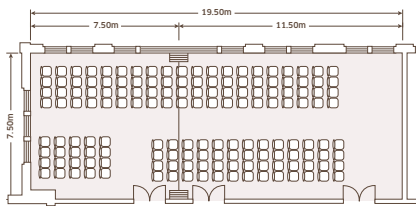
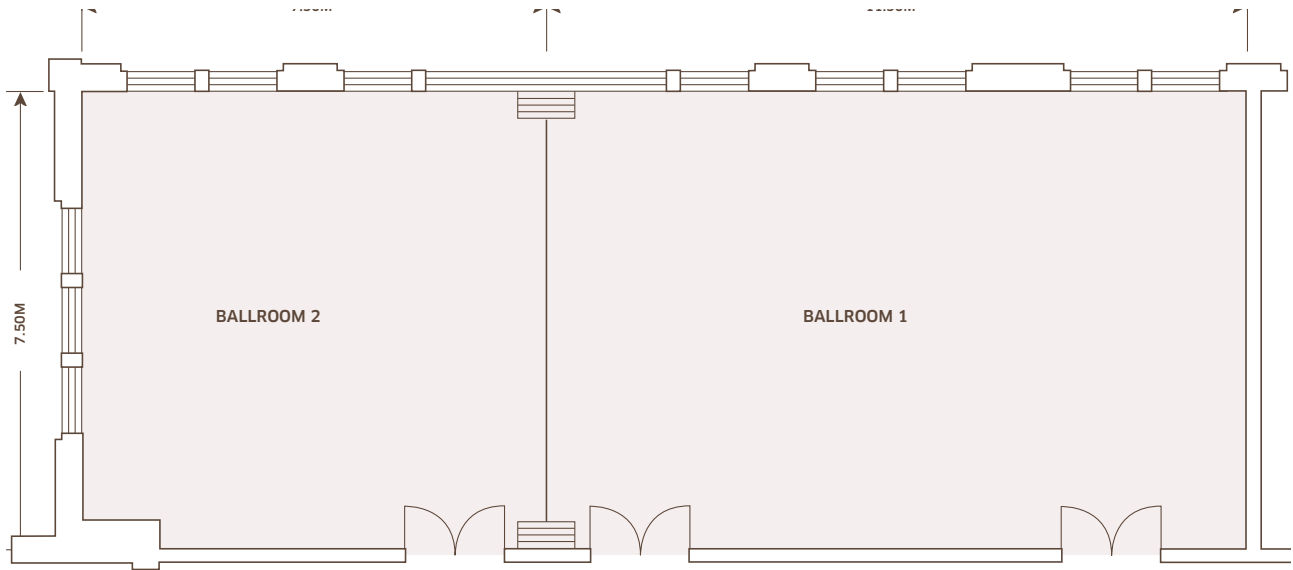

THEATRE

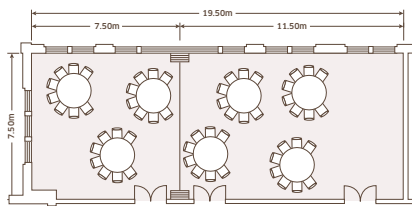

CABARET

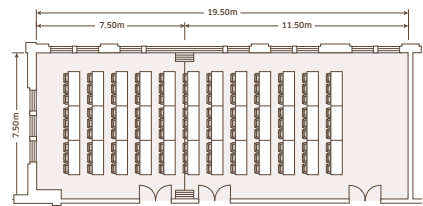

CLASSROOM

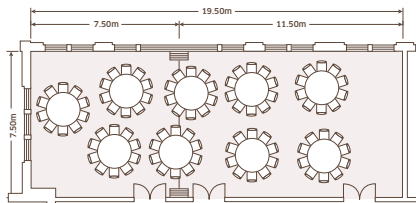

BANQUET

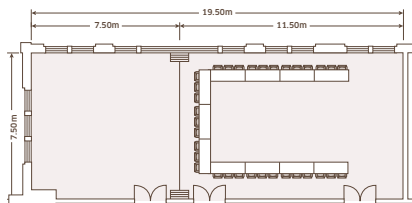

U-SHAPE

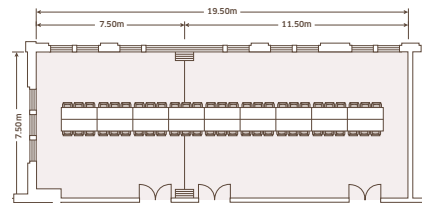

BOARDROOM

ROOM CAPACITIES

| | Area (sqm) | Height (m) | Theatre | Cabaret | Classroom | Cocktail | Banquet | U-shape | Boardroom |
|---------------------|------------|------------|---------|---------|-----------|----------|---------|---------|-----------|
| Ballroom | 146.2 | 4.4 | 100 | 80 | 80 | - | 100 | 45 | 44 |
| Ballroom One | 86.2 | 4.4 | 60 | 40 | 54 | - | 60 | 30 | 26 |
| Ballroom Two | 60.0 | 4.4 | 40 | 24 | 27 | - | 30 | 20 | 20 |

MANNIX

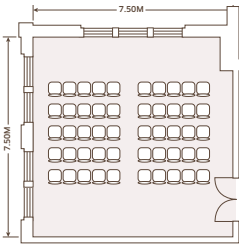
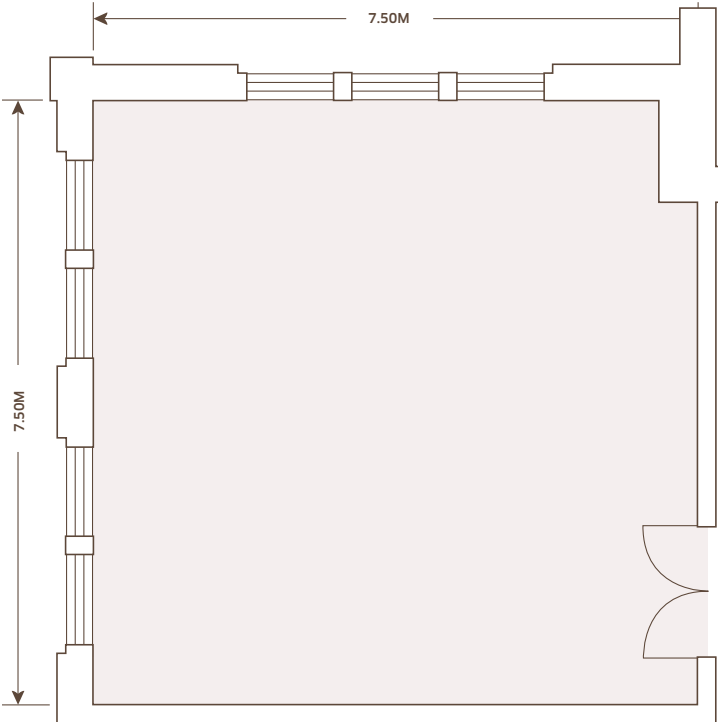

THEATRE

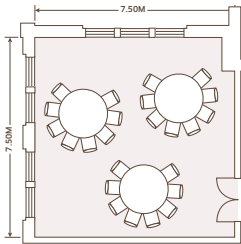

CABARET

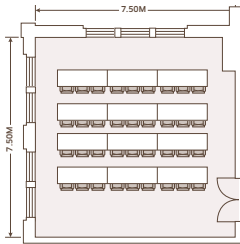

CLASSROOM

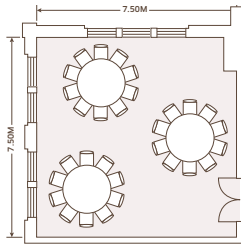

BANQUET

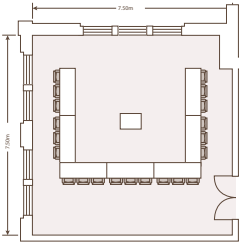

U-SHAPE

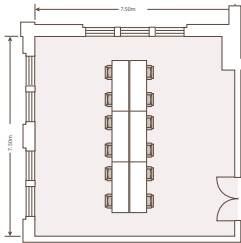

BOARDROOM

ROOM CAPACITIES

| | Area (sqm) | Height (m) | Theatre | Cabaret | Classroom | Cocktail | Banquet | U-shape | Boardroom |
|---------------|------------|------------|---------|---------|-----------|----------|---------|---------|-----------|
| Mannix | 56.7 | 4 | 40 | 24 | 27 | - | 40 | 20 | 20 |

BRENNAN

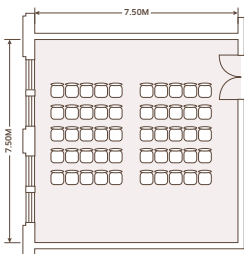
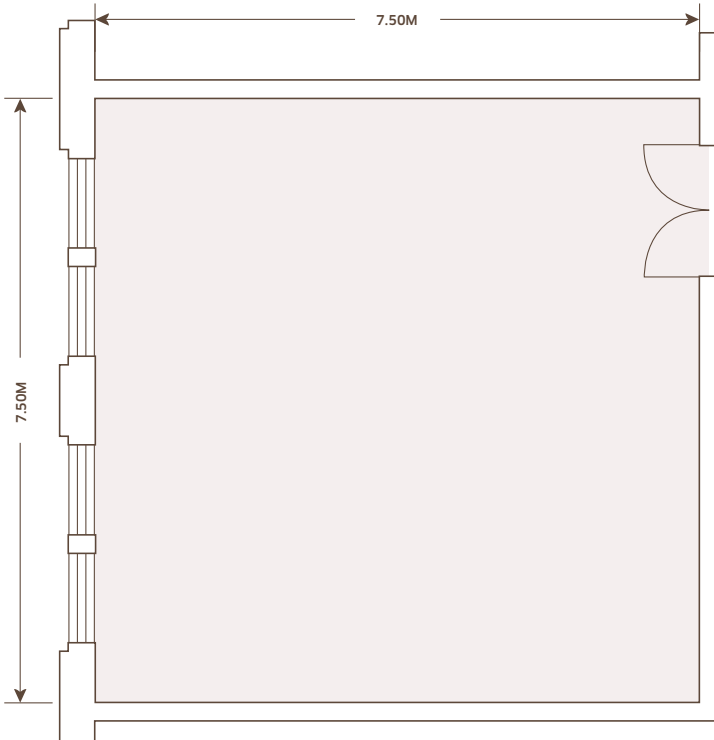

THEATRE

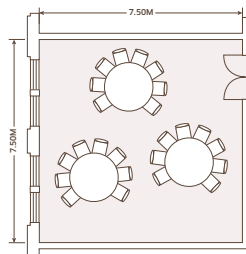

CABARET

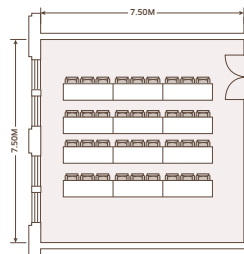

CLASSROOM

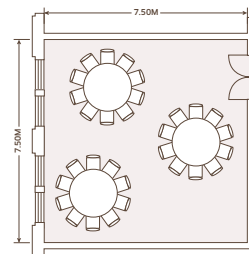

BANQUET

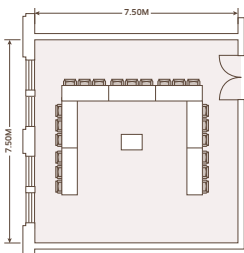

U-SHAPE

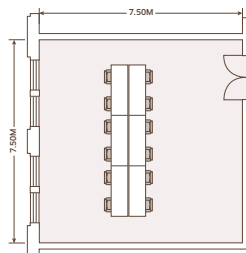

BOARDROOM

ROOM CAPACITIES

| | Area (sqm) | Height (m) | Theatre | Cabaret | Classroom | Cocktail | Banquet | U-shape | Boardroom |
|----------------|------------|------------|---------|---------|-----------|----------|---------|---------|-----------|
| Brennan | 56.2 | 4 | 40 | 24 | 27 | - | 40 | 20 | 20 |

THE THEATRE

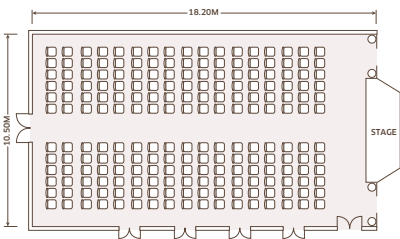

THEATRE

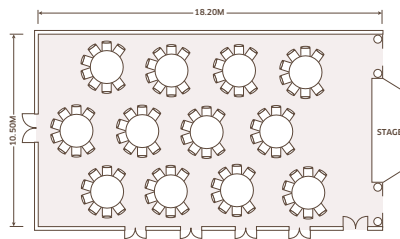

CABARET

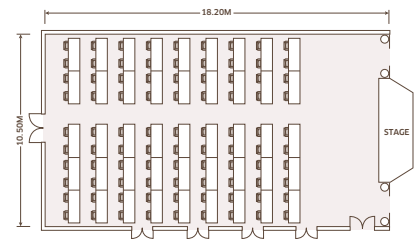

CLASSROOM

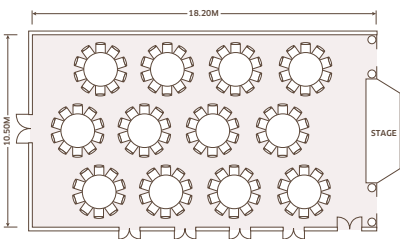

BANQUET

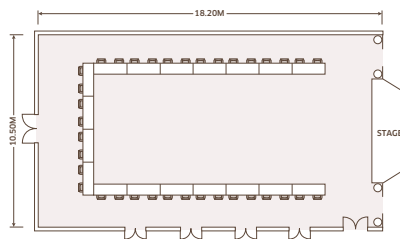

U-SHAPE

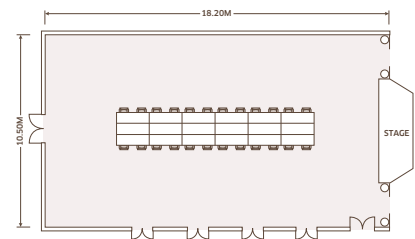

BOARDROOM

ROOM CAPACITIES

| | Area (sqm) | Height (m) | Theatre | Cabaret | Classroom | Cocktail | Banquet | U-shape | Boardroom |
|--------------------|------------|------------|---------|---------|-----------|----------|---------|---------|-----------|
| The Theatre | 180.0 | 6.5 | 140 | 112 | 96 | - | 140 | 56 | 48 |

THE PAVILION

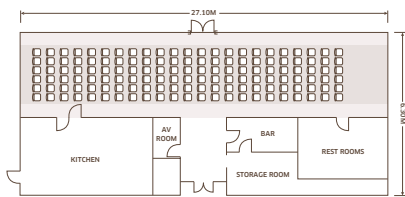
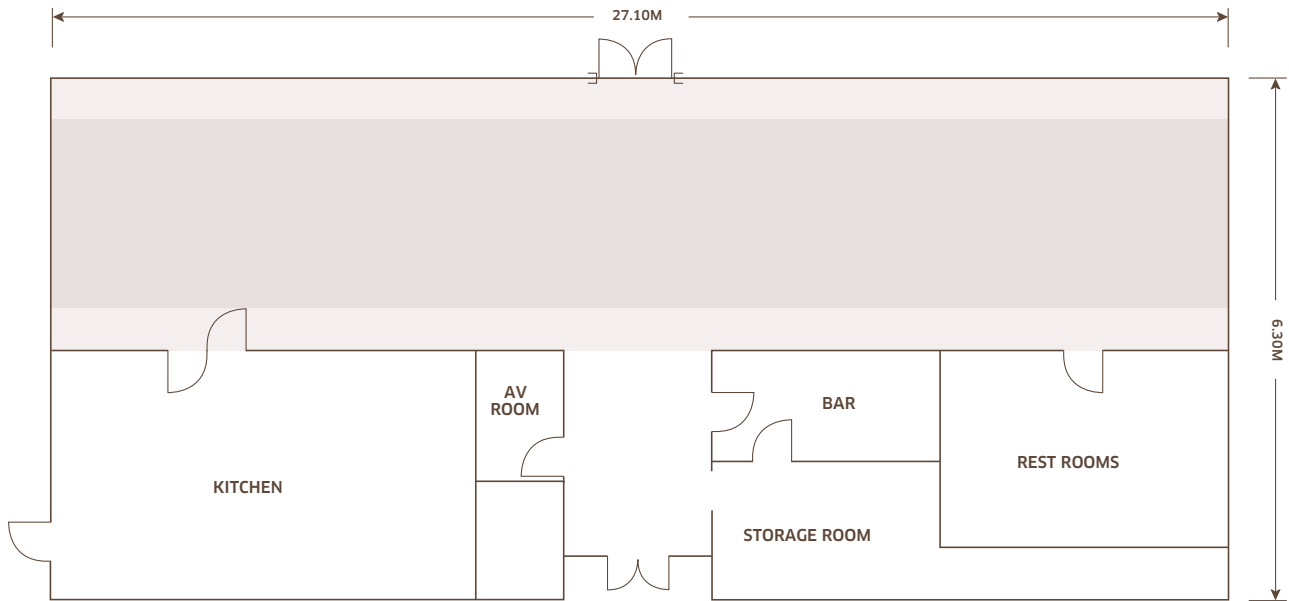

THEATRE

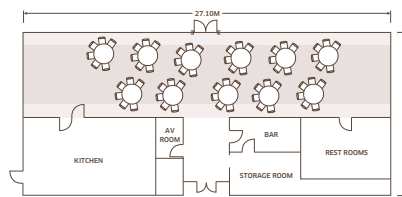

CABARET

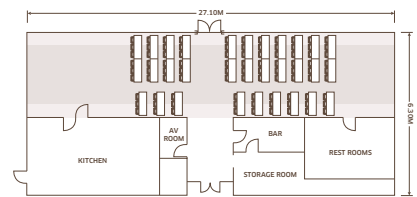

CLASSROOM

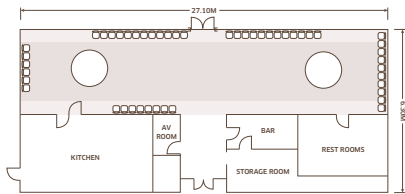

COCKTAIL

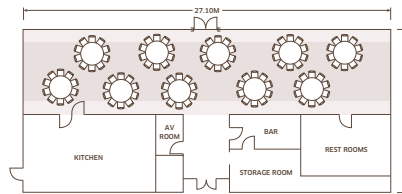

BANQUET

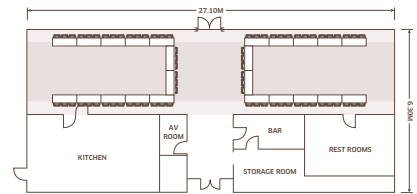

U-SHAPE

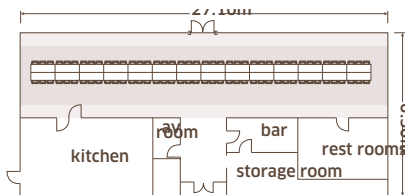

BOARDROOM

ROOM CAPACITIES

| | Area (sqm) | Height (m) | Theatre | Cabaret | Classroom | Cocktail | Banquet | U-shape | Boardroom |
|---------------------|------------|------------|---------|---------|-----------|----------|---------|---------|-----------|
| The Pavilion | 167.4 | 4.2 | 40 | 40 | 45 | 120 | 120 | 30 | 30 |

LANCEMORE
MANSION HOTEL
WERRIBEE PARK

Escarpment Rd, Werribee South VIC 3030

Phone – +61 3 9731 4000

Email – mansion@lancemore.com.au

Website – lancemore.com.au